



20 Skyline Terrace Burleigh Heads QLD

4 2 2

This stunning brand-new residence with a multi-functional floorplan over three levels with sweeping leafy outlooks imparts a contemporary edge and impeccable taste with quality finishes and is situated on the desirable Skyline Terrace located on the top of the hill so private and peaceful yet so close to all the Burleigh has to offer.

Upon entry the upper level showcases the master bedroom with built-in wardrobe and luxurious ensuite bathroom featuring double basins on custom hardwood vanity top and indulgent freestanding bath where you can relax and enjoy the peaceful green tree outlook. Adjoining the master is a living space or could be used as a home office.

From the flawless interior styling to the luminous open plan design and seamless merging of fabulous indoor/outdoor living spaces you will find the heart of the home on the

Price : \$ 1,250,000

View : <https://www.laceywest.com.au/sale/qld/gold-coast/burleigh-heads/residential/house/6144034>



Will West
07 5576 6616

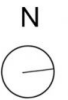
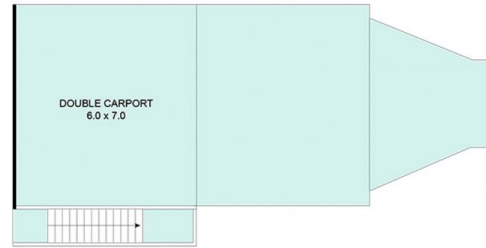

20 Skyline Terrace

Bed 4 | Bath 2 | Car 4

Internal Area 216m² | External 60m² | Carport 42m²

Total Floor Area - 318m²



Plans shown are for presentation purposes only and are not part of any lease, document or title. They are subject to errors, omissions, inaccuracies and should not be used as a sole and accurate reference. Interested parties should make their own inquiries using independent sources.